

ATEX: CML 19ATEX3390U
IECEx: CML 19.0133U
UKEX: CML 21UKEX31146U

BES5

FSEw-CT
FSEw-CF
FSUw-NF
SM-B
EMTS-CS

II 2GD
Ex 60079-30-1 IIC Gb
Ex 60079-30-1 IIIC Db

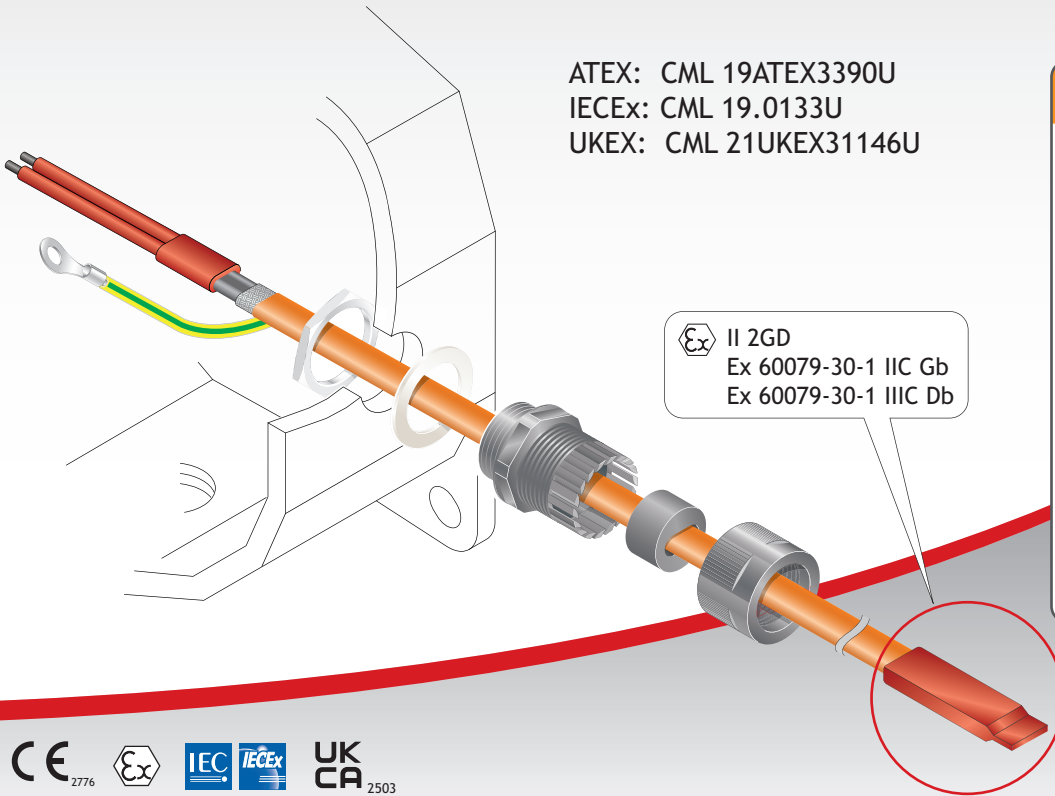

Made in the UK

FFG#			BPS#						BES5			RTV0.5

SPECIAL CONDITIONS FOR SAFE USE:

These termination kits and the cable that enters them shall be fixed to a secure mounting point.

The component shall only be used with constant power or self-regulating trace heating cables within the following ranges:
-40°C to 180°C (Standard RTV), -40°C to 250°C (High Temperature RTV).

This is particularly relevant when the trace heating cable is installed on pipework that has a temperature outside these ranges, in this situation, the termination devices shall be positioned outside the insulation, and the user/installer shall ensure that they are not exposed to UV radiation.

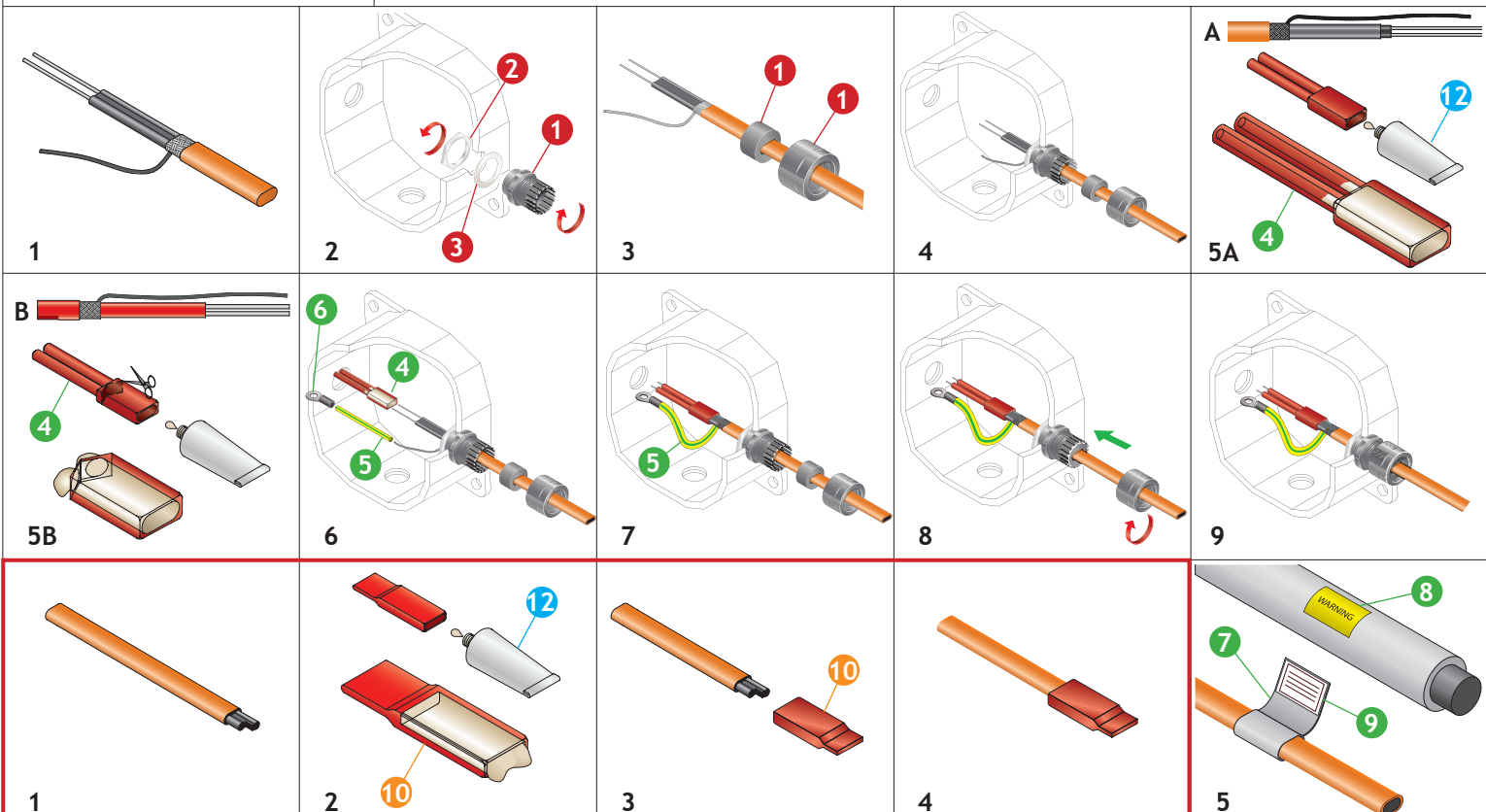

A

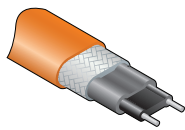
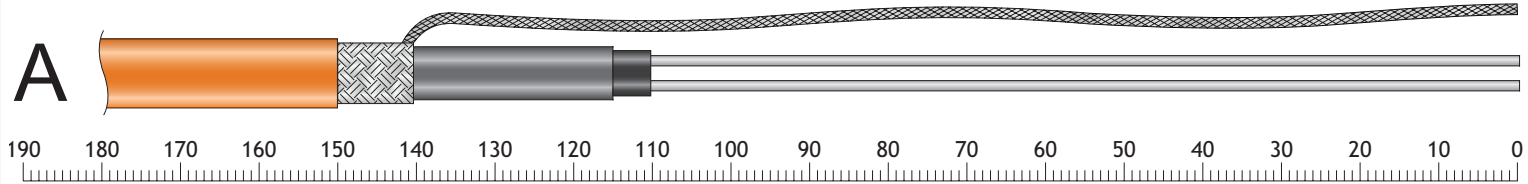

FSEw..CT

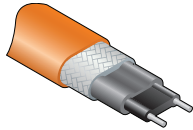

FSEw..CF

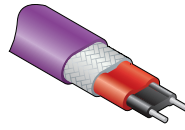

FSUw..NF

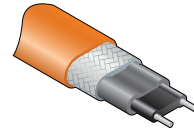

SMB

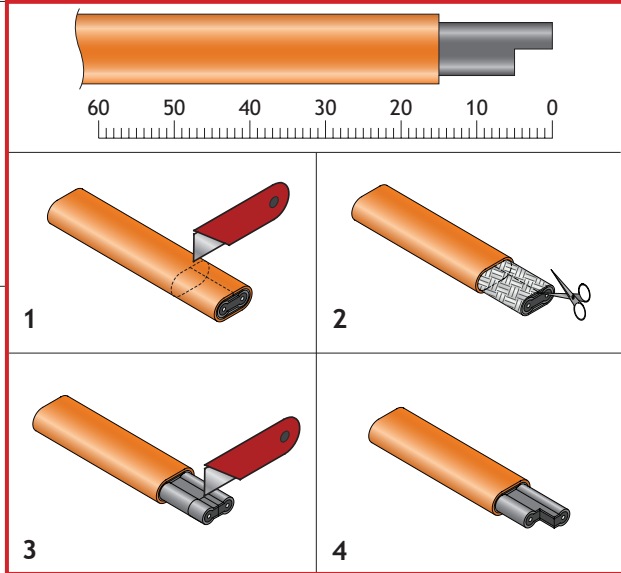
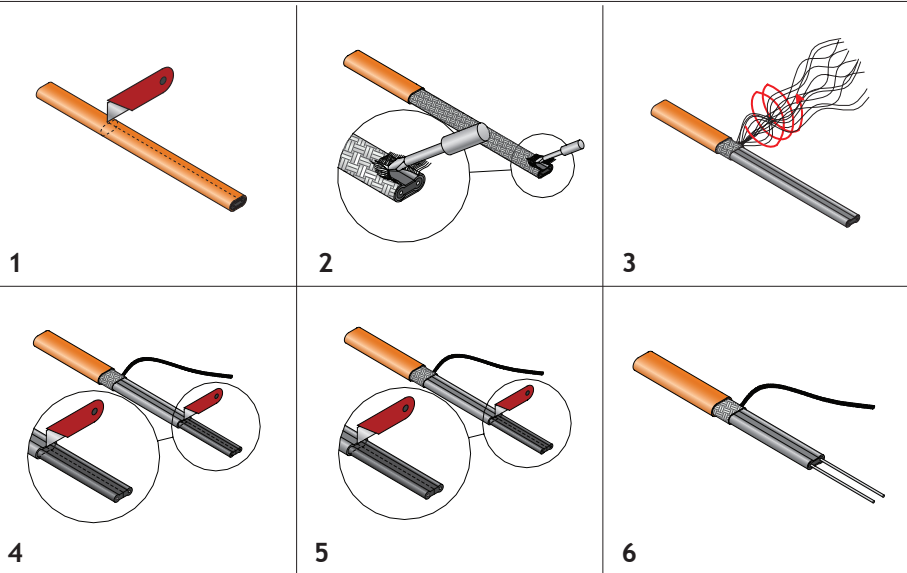

B

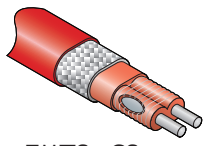
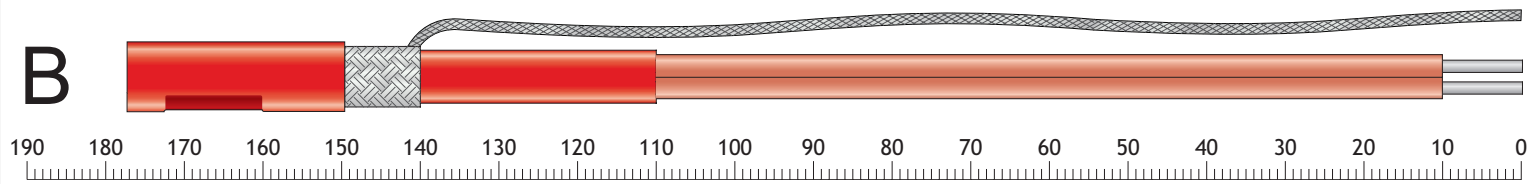

EMTS..CS

